

Housing guide

2024 - 2025



About this guide

Disclaimer: The reviews presented throughout this guide are not an endorsement from Arizona State University (ASU), ASU Off-Campus Housing, or Thunderbird School of Global Management.

ASU is not responsible for the contents of any linked sites to/from this guide. ASU has not checked or approved these businesses or properties for fire, heat, or safety conditions and makes no warranties or representations concerning these items. Individual property owners have the responsibility of ensuring a safe and healthy environment for renters.

Arizona State University, ASU Off-Campus Housing, or Thunderbird School of Global Management are not responsible for any errors, omissions, or misrepresentations in the information posted on other vendor sites linked to ASU websites. Property information, including program requirements, availability, features, safety conditions and rent ranges, should be verified independently with the property managers/landlords/vendors.

ASU does not work with individual students/tenants on a one-on-one basis to place them in housing. ASU does not guarantee that you will find the housing you are looking for, or will be placed in such housing. We strongly encourage students/tenants to do their own thorough research into each property in order to find the best housing options for their particular needs.

When signing a lease or any type of binding contract, it is very important to read all of the information. If you do not understand something in the lease, be sure to get a full definition and understanding prior to signing. Once a lease is signed, the student/tenant assumes full responsibility for location, condition and contractual terms of the off-campus rental.

We **STRONGLY** urge you to request references, research and visit any potential services or housing options.

If you have any questions, please contact Thunderbird's Student Success team at studentsuccess.tbird@asu.edu.

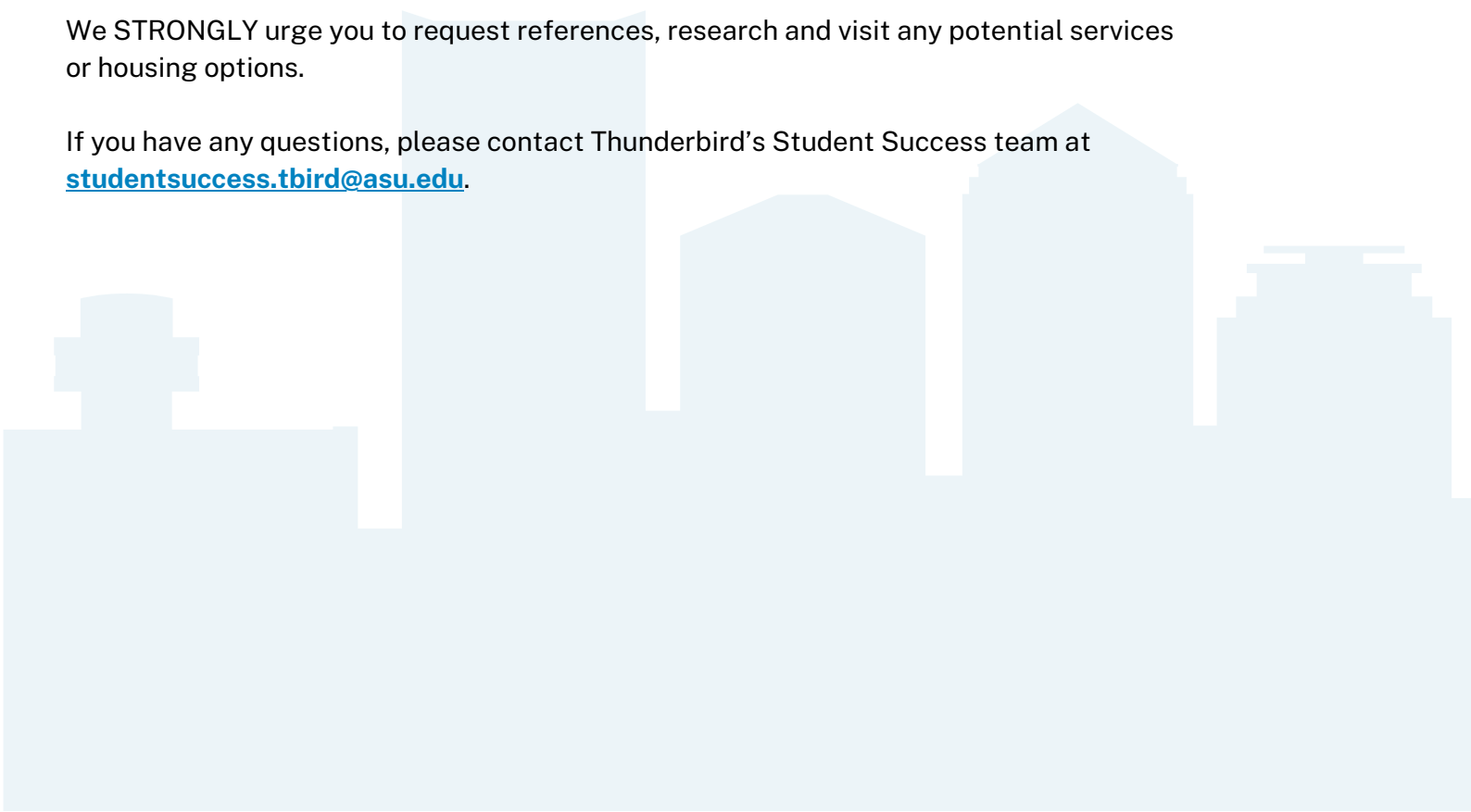



Fusion on First - ASU Housing

Seven minute walk to campus

Fusion on First is ASU Housing for upper division students, and the only ASU Downtown Phoenix campus option for Thunderbird graduate students.

For 2024-2025, there are 28 beds in Fusion on First (ASU Housing) reserved for Thunderbird graduate students. Each bed is located in a four-bedroom, two-bath floorplan apartment, and each student has their own room within the four-bedroom apartment. There are no other options for Thunderbird students in Fusion on First for 2024-2025.

Admitted students can apply to Fusion on First on a first-come, first-served basis here:

asu.starrezhousing.com/StarRezPortalX/883EAEC2/14/25/Home-Home?UrlToken=EA6AB1BB

ASU University Housing Policies: housing.asu.edu/housing-resources/housing-policies-and-procedures

Amenities

- Fully-furnished apartment style; full kitchen with upgraded appliances (full-size refrigerator/freezer, microwave, electric stove/oven, dishwasher, and sink with garbage disposal).
- Individual bedrooms, with a Full-sized bed, desk, four-drawer dresser, chair, and open closet.
- Living areas include a couch, TV stand, coffee table, and (in two- and four-bedroom units) a dining table with chairs.
- Laundry facilities on every floor (no additional fee for use).

Contact us

<https://housing.asu.edu/housing-communities/residential-colleges/fusion-on-first>

380 N. 1st Avenue, Phoenix, AZ 85003

Recommended apartments

From current Thunderbird students | In Phoenix

Property	Walk/drive time	Website
Altura	6 minute walk	alturaphx.com
Fusion on First	7 minute walk	housing.asu.edu/housingcommunities/residential-colleges/fusion-on-first
Joy on 4th	10 minute walk	www.joyon4thapartments.com
Kenect Phoenix	1 minute walk	www.kenectphoenix.com
Lydian Apartments	18 minute walk	liveatlydian.com
Mason Oliver Apartments	24 minute drive	www.masonoliverapartments.com
Moon Tower	7 minute walk	moontowerphoenix.com
Mozaic at Steel Park Apartment Homes Apartments	10 minute drive	arizona.weidner.com/apartments/az/phoenix/mozaic-at-steele-park-0
Proxy 333	10 minute walk	arizona.weidner.com/apartments/az/phoenix/proxy333-0
Roosevelt Point	13 minute walk	www.rooseveltsquareapts.com
Skye	7 minute walk	skyeon6th.com/gallery
Skyline Lofts	8 minute walk	arizona.weidner.com/apartments/az/phoenix/skyline-lofts-0
The McKinley Apartments	11 minute drive	www.themckinleyapartments.com/#section-1
The Met at 3rd and Fillmore	6 minute walk	www.themetapartmenthomes.com
The Muse	22 minute walk; 6 minute drive	musephoenix.com

Arizona State University/Thunderbird School of Global Management do not endorse any property on this list. This listing was compiled as a resource for students.

Additional downtown Phoenix apartments

Property	Walk/drive time	Website
Altura	7 minute walk	alturaphx.com
Camden Cooper Square Apartments	14 minute walk	www.camdenliving.com/apartments/phoenix-az/camden-copper-square
Capital Place 11	25 minute walk; 5 minute drive	www.rentdeals.com/apartments/az/phoenix/capital-place-by-mark-taylor
City Scape Residences	10 minute walk	cityscaperesidences.com
Continental Apartments	13 minute walk	www.thecontinentalapartments.com
Fountains in the Green	10 minute drive	fountainsinthegreen.com
Green Leaf Arts District	21 minute walk; 5 minute drive	www.greenleafartsdistrict.com
iLuminate Apartments	12 minute walk	www.iluminate290.com/#section-1
Inhabit on Seventh Apartments	15 minute drive	www.inhabiton7th.com
Linear Apartments	10 minute walk	www.linear295.com
Parc Midtown	11 minute drive	parcmidtownapts.com
Roosevelt Row	10 minute walk	arizona.weidner.com/apartments/az/phoenix/roosevelt-row
Station on Central	12 minute drive	www.maxxproperties.com/az/phoenix/the-station-on-central-0
X Phoenix	9 minute walk	www.thexlife.co/xphoenix

*To see pictures and amenities of some of these apartments, visit: www.apartments.com

**Check with each apartment complex on whether or not the apartment is furnished or unfurnished.

Arizona State University/Thunderbird School of Global Management do not endorse any property on this list. This listing was compiled as a resource for students.

Recommended apartments

From current Thunderbird students | Outside of Phoenix

Property	City	Walk/drive Time	Website
Alight Tempe	Tempe	22 minute drive	alight-tempe.com
Avana Tempe	Tempe	20 minute drive	avanatempe.com
Canvas Tempe	Tempe	22 minute drive	www.canvastempe.com
District on Apache	Tempe	18 minute drive	www.thedistrictonapache.com
Gateway at Tempe	Tempe	18 minute drive	gatewayattempe.com
Liv Crossroads	Gilbert	31 minute drive	livcrossroads.com
Nexa Apartments	Tempe	22 minute drive	livenexa.com
Nine 20 Tempe	Tempe	22 minute drive	nine20tempe.com
Paseo on University	Tempe	20 minute drive	www.paseoonuniversity.com
University House Tempe	Tempe	23 minute drive	uhtempe.com
Villagio Apartment Homes	Tempe	23 minute drive	villagioapartmenthomes.com
Villas on Apache	Tempe	21 minute drive	www.villasonapache.com

ASU Off Campus Housing Resource: offcampushousing.asu.edu/listing

*To see pictures and amenities of some of these apartments, visit: www.apartments.com

**Check with each apartment complex on whether or not the apartment is furnished or unfurnished.

Arizona State University/Thunderbird School of Global Management do not endorse any property on this list. This listing was compiled as a resource for students.



Nexa Apartments



Nine 20

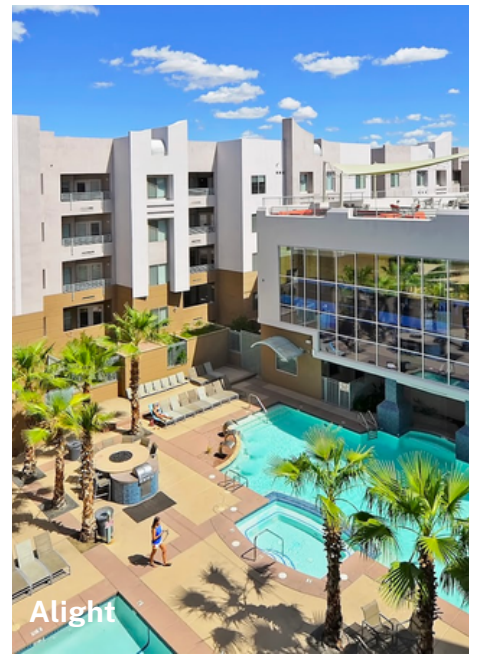

Alight



Liv Crossroads

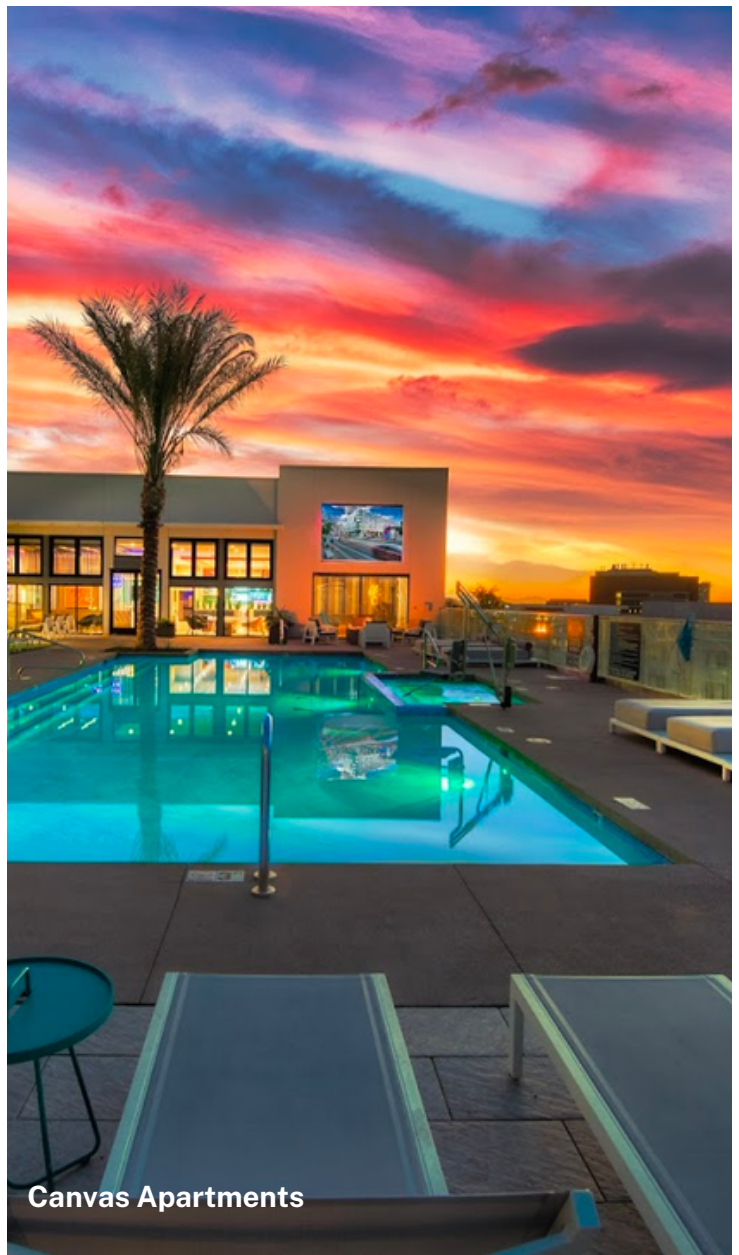

Canvas Apartments



Villagio Apartment Homes

Arizona State University/Thunderbird School of Global Management do not endorse any property on this list. This listing was compiled as a resource for students.

Neighborhoods in downtown Phoenix

Downtown Phoenix Neighborhoods: <https://dtphx.org/live/neighborhoods/>

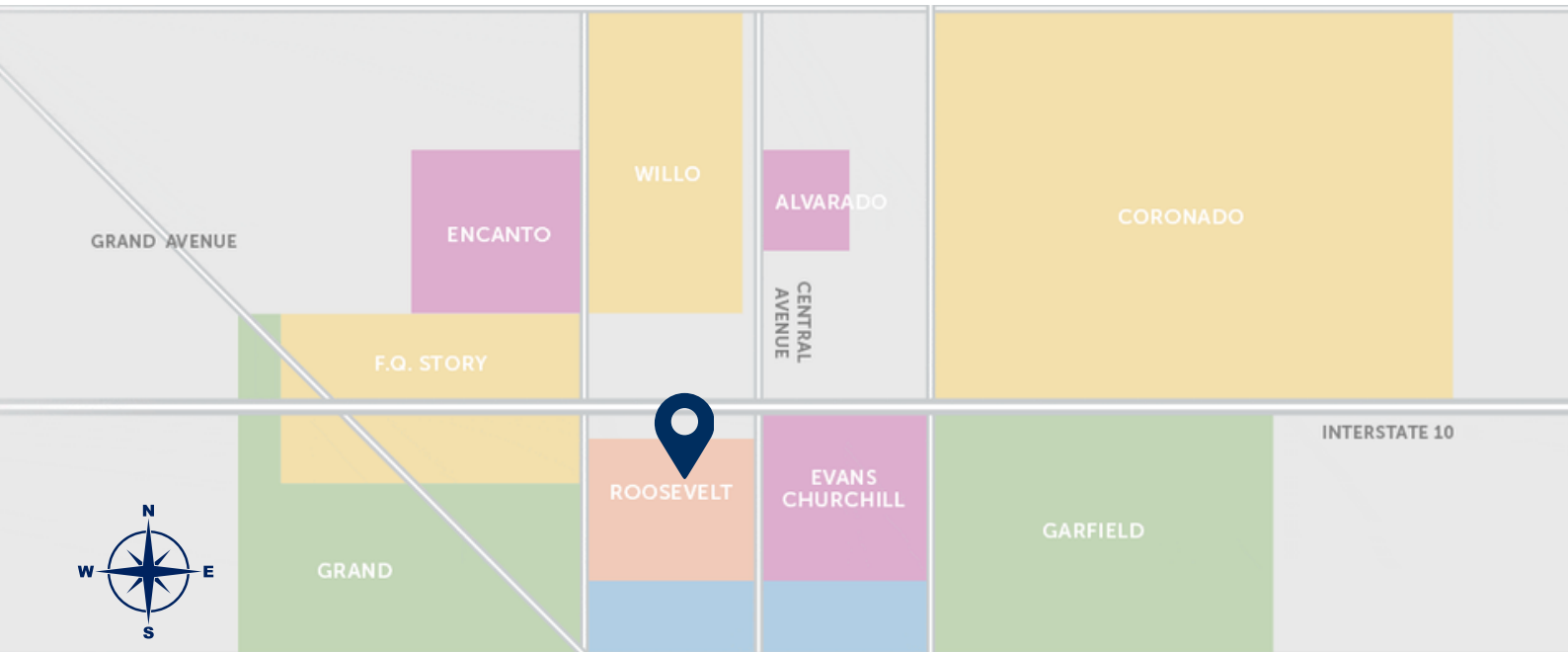

Roosevelt

The historic Roosevelt neighborhood is the first in downtown Phoenix to receive a historic distinction. The neighborhood is positioned between 7th Avenue to the west and Central Avenue to the east. From north to south, Roosevelt begins near McDowell Road and ends near Van Buren Street.

ASU students find the area to have relatively affordable housing options compared to other downtown neighborhoods and within walking distance to Thunderbird School of Global Management. Several students also point out its convenience to the light rail and the neighborhood is generally quiet and safe.

PROS

- Close proximity to nightlife.
- Decent prices and location.
- Great dog parks and green spaces.

CONS

- Crowds during First Fridays.
- The stand alone homes are older and tend to need a lot of repair.

Distance from Thunderbird:



10 - 15
Minutes



4 - 6
Minutes



8 - 9
Minutes

Grocery

Safeway

Parks

Margaret T. Hance Park
Japanese Friendship Garden
Hance Dog Park

Restaurants

The Habit Burger Grill
Zoes Kitchen
The Old Spaghetti Factory
Pita Jungle
Fez
Matt's Big Breakfast

Entertainment

The Vig Filmore
Angel's Trumpet Ale House
Sazerac
Arizona Wilderness DTPHX

Neighborhoods in downtown Phoenix

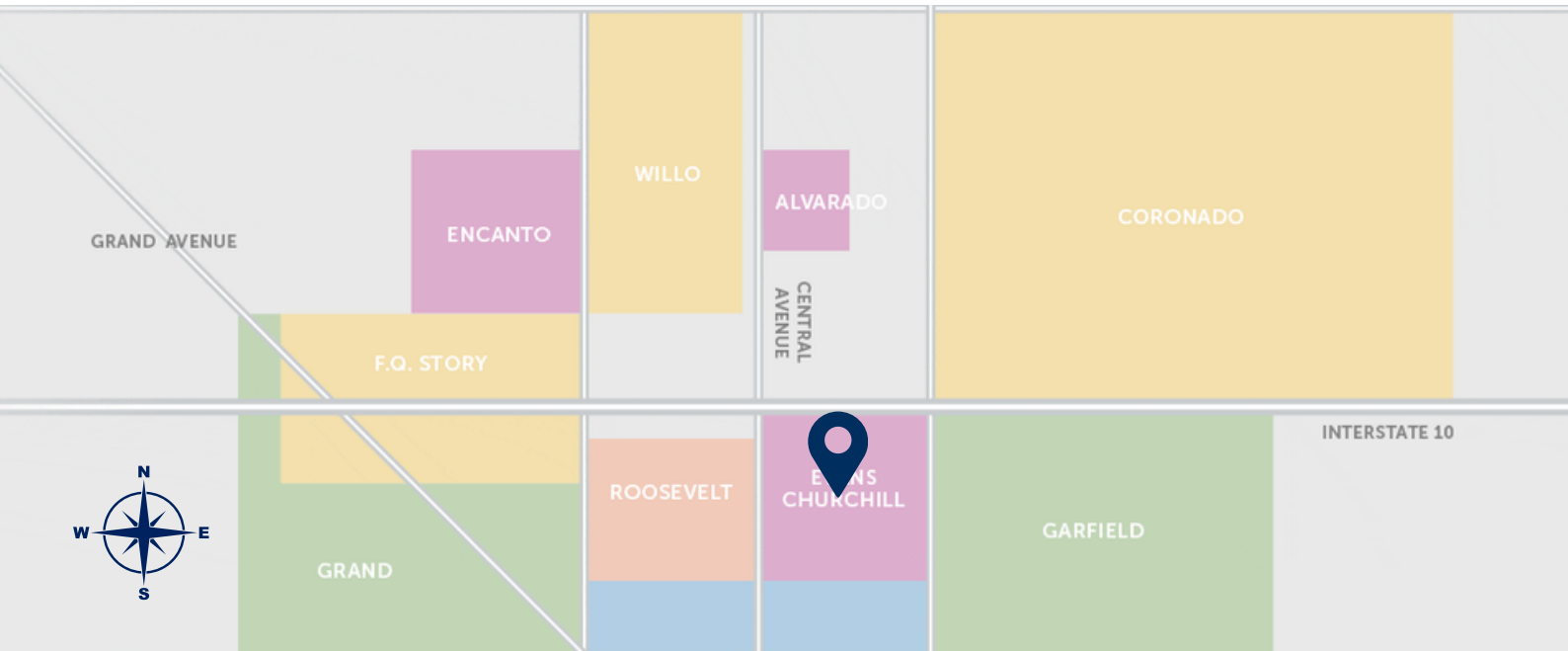

Evans-Churchill

The Evans-Churchill neighborhood sits next to the Phoenix Downtown Core and is home to Roosevelt Row which houses the arts district and hosts First Fridays and Third Fridays gallery night. The neighborhood expands north to McDowell Road and south to Fillmore Street. It goes west to Central Avenue and east to 7th Street.

ASU students living in Evans-Churchill benefit from its close proximity to Thunderbird. The neighborhood boasts numerous biking paths and trails for the outdoor enthusiast. Students tend to go to the weekly farmer's markets as the closest grocery stores can be a trek.

PROS

- Walking distance to fitness studios.
- Close to farmers market.
- Pedestrian/bicycle-friendly community.

CONS

- Traffic and congestion during peak hours.
- High property prices.
- Crowds.

Distance from Thunderbird:



10 - 15
Minutes



4 - 6
Minutes

Grocery

Fry's Food and Drug Store

Restaurants

Pizzeria Bianco
Bitter & Twisted
Chipotle Mexican Grill
Bosa Donuts

Entertainment

Footprint Center
Chase Field

Neighborhoods in downtown Phoenix

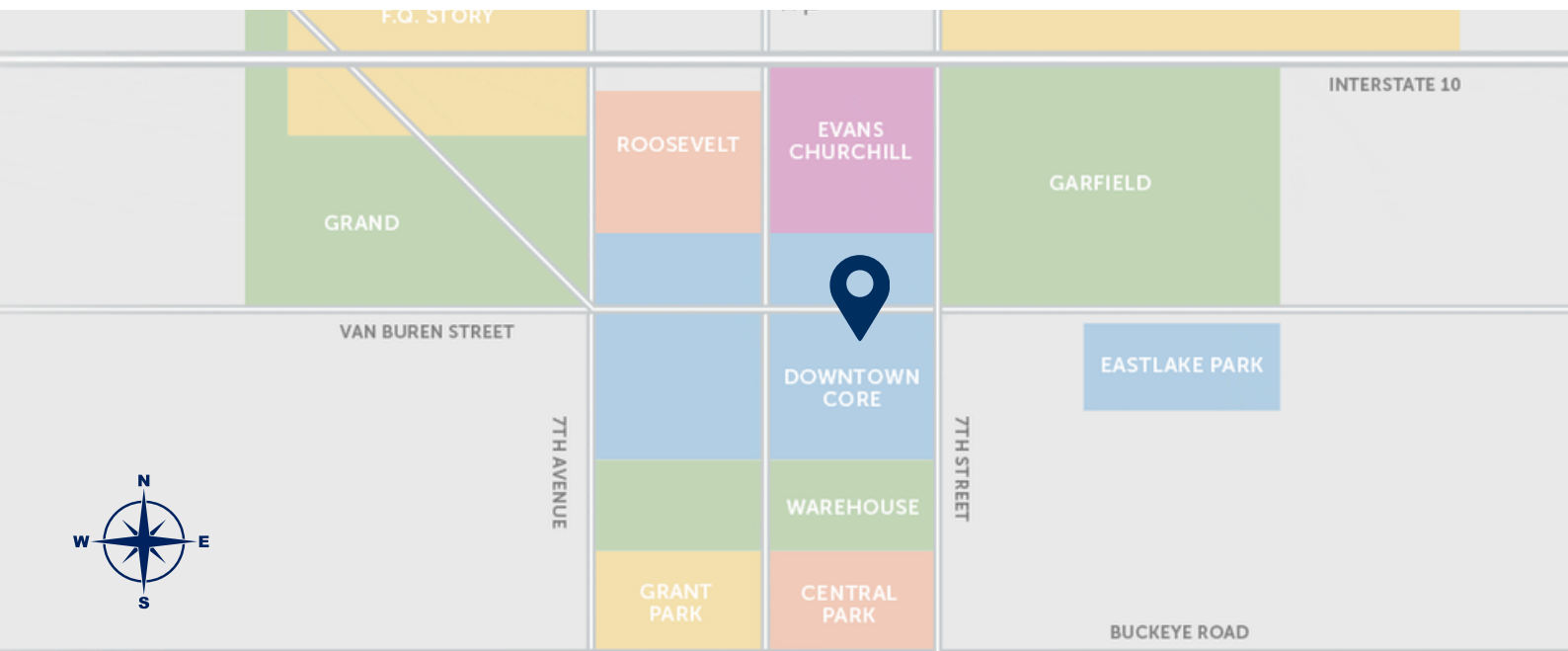

Downtown Core

The Downtown Core boasts a great mix of rental properties and access to restaurants and cultural attractions. The neighborhood is bounded by Fillmore Street to the north, down south to East Lincoln Street, west of 7th Street and east of 3rd Avenue.

ASU students appreciate the true urban vibe of the Downtown Core. The neighborhood is conveniently located near the courts and major firms, making it easy to go from class to externships. A large Fry's grocery store opened in the Downtown Core, which makes grocery shopping more accessible. There is also a growing selection of restaurants and bars.

PROS

- Watch a game at Footprint Center or Chase Field.
- Close proximity to downtown internships.

CONS

- Traffic and congestion during events and sporting games.
- High property prices.

Distance from Thunderbird:



15 - 20
Minutes



5 - 8
Minutes



8 - 10
Minutes

Grocery

Fry's
Farmers Market
Pacific International Marketing

Restaurants

Matt's Big Breakfast
POMO Pizzeria
Chambers

Entertainment

The Irish Cultural Center
Phoenix Symphony Hall
AMC Theater
Arizona Center

Advice from current Thunderbird graduate students on renting:

1. It took some time to find, but luckily, I had a roommate that found it!
2. Had to start searching for housing very early and had to begin renting in July to secure residence.
3. I needed a guarantor, and it is not easy for everyone to find one (from an international student).
4. I needed to make a deposit before securing my off-campus housing.
5. I found my housing through Facebook pages and WhatsApp groups.
6. It was hard knowing how accessible complexes were in comparison to campus. It was very difficult navigating finding housing without being in Phoenix. I did not know all my options.
7. In some apartment locations, you do not have to have roommates to get the multiroom apartments where the rent is less expensive. The apartment can pair you up with other students.
8. Apply as soon as possible as places fill up very quickly!
9. Try to meet your roommates before planning to live with them.
10. Rent is higher in downtown Phoenix, but the benefit is that you can walk to class!
11. The Phoenix and Arizona market is crazy expensive right now!
12. If you live in Tempe, you can take the light rail (with a student pass) to downtown Phoenix, or the ASU campus shuttle (for free).
13. Make sure to ask what is included in your monthly rental fees.
14. Be sure to find out if the apartment is furnished or unfurnished, and then determine what is needed.
15. Factor in the cost of renter's insurance (if you want to purchase it).
16. Let domestic students know they should look into government assistance that they qualify for as graduate students.
17. Taking the ASU (free) shuttle from the ASU Tempe campus to ASU's Downtown Phoenix campus takes 20-30 minutes each way.

General tips and advice for renters

Look out for red flags

- Links to free credit reports by landlord.
- Filling out an application before seeing a unit or meeting the landlord.
- Paying money or a wire request before seeing the unit or meeting the landlord.
- Prices that look too good to be true. Ask questions and check out rental rates in the area.
- If corresponding via email, be sure to contact the landlord in person or via a phone call directly.
- Sub-leasing, be sure to verify the information directly with the landlord or apartment complex.

Roommate matching

Many off-campus living communities offer roommate matching services very similar to what you would find on-campus. It is important to ask any place of interest if they offer this service. Your Thunderbird class Facebook page is a great way to connect with other students to find a roommate or learn where other students plan on living. If you want an apartment to yourself, let the leasing office know right away.

Note for international students

In the United States, apartment complexes require proof of income from a local employer. For many international students, this is not possible, so students are asked to provide a co-signor or guarantor who is a permanent resident or citizen of the United States. If students are unable to provide a guarantor, a sublease could be the answer or renting a room. We recommend that you check out the [ASU Housing Sublets & Roommates Facebook](#) page for sublease and rental options.

Furniture resources

There are several places to rent furniture for short-term use or buy used furniture. Many apartments offer furniture in their rentals. It is important to ask if furniture is available in a rental or not. For international or out-of-state students, having an apartment that offers furniture is helpful. You can also check out the following:

- Salvation Army
- Gracie's Thrift
- IKEA
- Habitat for Humanity ReStore
- Maggie's Thrift
- Wayfair



Transportation resources

Several public transportation options are available to ASU students, faculty and staff across all four ASU campuses. Sun Devils may purchase discounted transit passes to ride Valley Metro buses and light rail.

- **ASU campus shuttles:** cfo.asu.edu/shuttles
- **ASU parking permits:** cfo.asu.edu/permits
- **ASU public transit options in phoenix:** cfo.asu.edu/transit
- **Public transportation options in Phoenix (non-ASU resource):** www.visitphoenix.com/plan-a-trip/transportation/public-transportation/



ASU Campus safety

eoss.asu.edu/dos/safety

Arizona State University (ASU) provides a safe, healthy, and secure environment. Maintaining a healthy and secure campus community for students, staff, and faculty means knowing what to do in the event of an emergency and having the right tools to respond. In order to achieve this, the university offers education and multiple resources to ensure that all members of the university are safe and secure.

Emergency contacts

- ASU Police 911 (Non-emergency: cfo.asu.edu/police-directory)
- Counseling Services (Students) 480-965-6146
- EMPACT Suicide and Crisis Line 480-921-1006
- Emergency Response Guide: cfo.asu.edu/emergency-guide

ASU LiveSafe APP

ASU has created the LiveSafe Mobile app (more information can be found here: cfo.asu.edu/livesafe-mobile-app). The GoSafe Function can be used to activate SafeWalk and text with your friends or family during your trip as they view your progress on a map. Deactivate SafeWalk after your trip. *Please note that the student-run Safety Escort Service on this app is only available on the ASU Tempe campus.*

Additional information

For those interested, there are also self-defense classes offered on both the ASU's Downtown Phoenix and Tempe campuses. If you would like more information you can find it here: cfo.asu.edu/police-resources.

Additional Campus Resources

- [ASU Counseling Services](#)
- [Alcohol Education](#)
- [Employee Assistance](#)
- [Fire Safety](#)
- [Health Services](#)
- [Public Safety](#)
- [Safety Escort](#)
- [Sexual Violence](#)
- [Student Advocacy](#)
- [Student Rights and Responsibilities](#)
- [Wellness](#)

